



ASPIRE

— TO MOVE —



Bladud Buildings, Bath, BA1

Video and physical viewings available. Student two bedroom garden flat located in Bath city centre. Available 4th September 2026.

Bladud buildings is located to the north of Bath city centre and provides excellent access to local amenities on George Street, 0.1 miles away. There is a bus stop 0.2 miles away on Milsom Street.

- Garden Flat
- Two double bedrooms
- Students accepted
- Furnished
- Video viewing available
- Council tax band B: if applicable
- Available 4th September
- Holding deposit - £403.00

£1,750 PCM

Floor Plans

LOWER GROUND FLOOR 531 sq.ft. (49.3 sq.m.) approx.

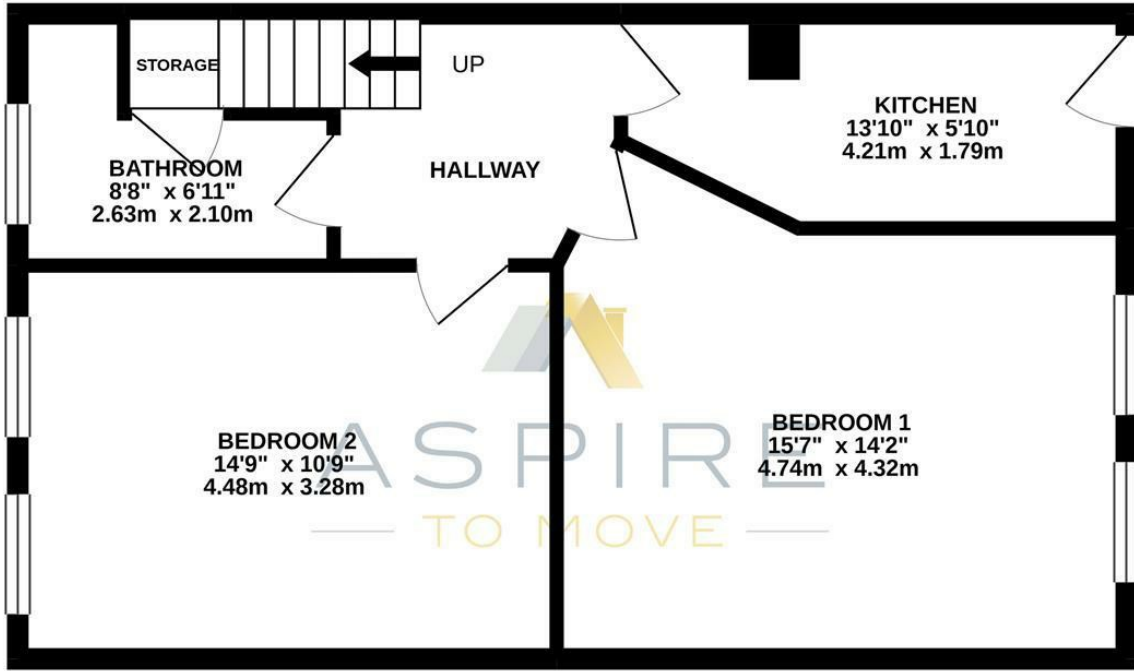

10 BLADUD BUILDINGS

TOTAL FLOOR AREA : 531 sq.ft. (49.3 sq.m.) approx.

Whilst every attempt has been made to ensure the accuracy of the floorplan contained here, measurements of doors, windows, rooms and any other items are approximate and no responsibility is taken for any error, omission or mis-statement. This plan is for illustrative purposes only and should be used as such by any prospective purchaser. The services, systems and appliances shown have not been tested and no guarantee as to their operability or efficiency can be given.
Made with Metropix ©2020

Energy Performance Graph

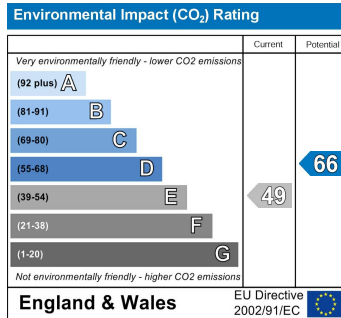
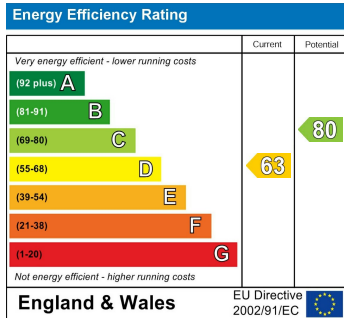

These particulars, whilst believed to be accurate are set out as a general outline only for guidance and do not constitute any part of an offer or contract. Intending purchasers should not rely on them as statements of representation of fact, but must satisfy themselves by inspection or otherwise as to their accuracy. No person in this firm's employment has the authority to make or give any representation or warranty in respect of the property.